

# Unit 6

## Waterproofing of static in cast-in-situ structure under construction

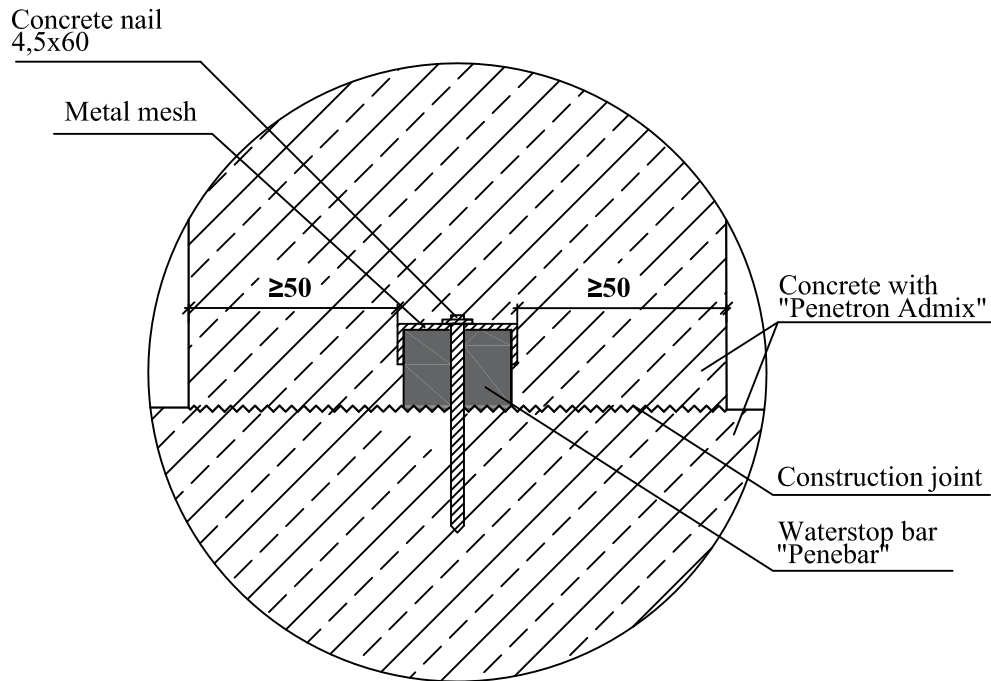

Note:

Use concrete of the design strength with admixture "Penetron Admix" for concrete pouring

Application of the materials:

1. Fix Penebar with metal mesh and concrete nail on the surface. Mind the distance from the edge of the wall. It should not be less than 50 mm.
2. Prepare Penetron Admix in ratio of 0.6-0.7L of water per 1 kg of a dry admixture or by volume - 1 portion of water per 1.5 portion of a dry admixture. Consumption of the Penetron Admix waterproofing admixture is 1% of cement weight in a concrete mix or 4 kg of the Penetron Admix per 1m<sup>3</sup> of concrete.
3. Add/pour the slurry in a ready mix truck.
4. After being added to a concrete mix, the Penetron Admix mortar is stirred in a ready mix truck for at least 10 minutes. The Penetron Admix waterproofing admixture may be used without limitation with any other admixtures in concrete.