

Unit 5

Existing structure Active leaks removal

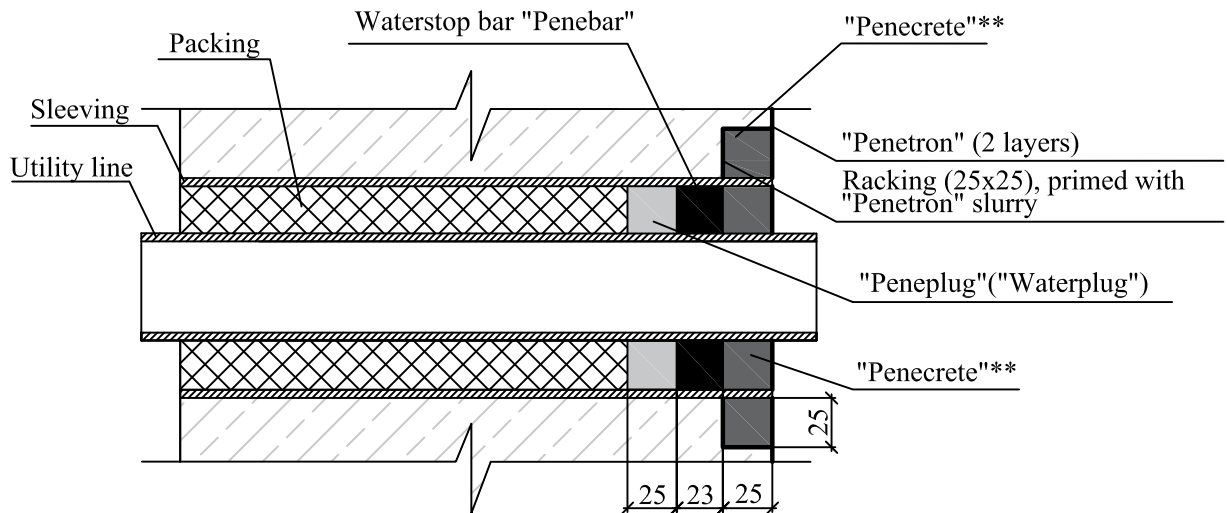

*used in case of active leaks at the moment of work performance, if there are no leaks, "Penecrete" should be used
**"Penecrete" is used for waterproofing of the joint between the sleeveing and in the absence of vibration and temperature impacts

Application of the materials:

1. Clean the communication inlet mechanically, using high-pressure water unit.
2. Prepare such amount of the Peneplug/Waterplug mix that can be used within 30 sec/2 min. The optimum temperature of tempering water is 20 ± 2 °C. Use only clean containers and water to prepare a mortar mix. Mix the Peneplug / Waterplug dry mix with water in the following ratio: 0.22L of water per 1 kg of the Peneplug/Waterplug dry mix, or by volume - 1 portion of water per 4 portions of the Peneplug/Waterplug dry mix. Pour water in a dry mix and during 15-20 seconds.
3. Form a dense hard cone with the size not exceeding the size of a leakage cavity. Put the cone into the cavity with thumbs (in alkali resistant gloves only).
4. Put Penebar around the inlet.
5. Prime with one layer of the mortar mix Penetron.
6. Prepare such amount of the Penecrete mortar that can be used within 30 minutes. Mix a dry mix with water in the following ratio: 0.17-0.18L of water per 1 kg of the Penecrete dry mix, or by volume - 1 portion of water per 5 portions of the dry mix. Stir the Penecrete mortar mix for 1-2 minutes manually or with a slow-speed drill until the thick plastic consistency is achieved.
7. Fill the inlet cavity with Penecrete mortar mix. The thickness of the applied layer of the Penecrete mortar mix shall not exceed 30 mm; deep holes are filled with several layers.
8. Apply Penetron slurry onto the surface in two layers without gaps. The first layer shall be applied to damp concrete and the second - to the first layer fresh but already set. Before applying the second layer, the surface should be moistened. The consumption of the dry mix Penetron is 0.8-1.1 kg/m² of the concrete surface.